

# Three Hole Flat Corner Bracket



## FEATURES

Used to create metal frames with nVent CADDY Eristrut channels

## SPECIFICATIONS

Table 1/2

Catalog Number	Article Number	Material	Finish	A	B	Screw Included
ZE107	313070	Steel	Hot-Dip Galvanized	85 mm	85 mm	Yes
ZEA107S6	387572	Stainless Steel 316 (EN 1.4401)		85 mm	85 mm	No
ZEA107	387570	Steel	Hot-Dip Galvanized	85 mm	85 mm	No
ZEA107EG	387571	Steel	Electrogalvanized	87.5 mm	87.5 mm	No

Table 2/2

Catalog Number	Article Number	Screw Diameter (Sc)	Screw Length (L)
ZE107	313070	10 mm	25mm
ZEA107S6	387572		
ZEA107	387570		
ZEA107EG	387571		

## DIAGRAMS

---

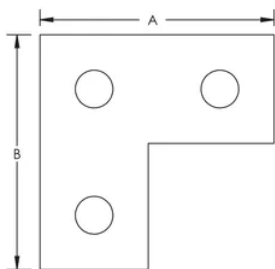

## WARNING

---

nVent products shall be installed and used only as indicated in nVent's product instruction sheets and training materials. Instruction sheets are available at [www.nvent.com](http://www.nvent.com) and from your nVent customer service representative. Improper installation, misuse, misapplication or other failure to completely follow nVent's instructions and warnings may cause product malfunction, property damage, serious bodily injury and death and/or void your warranty.

### North America

+1.800.753.9221

Option 1 – Customer Care

Option 2 – Technical

Support

### Europe

Netherlands:

+31 800-0200135

France:

+33 800 901 793

### Europe

Germany:

800 1890272

Other Countries:

+31 13 5835404

### APAC

Shanghai:

+ 86 21 2412 1618/19

Sydney:

+61 2 9751 8500



Our powerful portfolio of brands:

**CADDY**

**ERICO**

**HOFFMAN**

**ILSCO**

**SCHROFF**

**TRACHTE**

