

Electrical Box Bracket to Stud

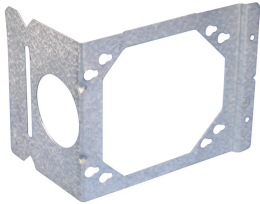

CERTIFICATIONS



FEATURES

Easily attaches 4" and 4 11/16" outlet boxes to metal or wood studs

Support leg reduces movement of box in wall

Offset design and use of SMS8 low profile self-tapping screws (not included) reduce dry wall bulge

SPECIFICATIONS

Table 1/1

Catalog Number	Material	Finish	Stud Wall Depth
H46TC	Steel	Pregalvanized	101.6mm, 152.4mm

WARNING

nVent products shall be installed and used only as indicated in nVent's product instruction sheets and training materials. Instruction sheets are available at www.nvent.com and from your nVent customer service representative. Improper installation, misuse, misapplication or other failure to completely follow nVent's instructions and warnings may cause product malfunction, property damage, serious bodily injury and death and/or void your warranty.

North America

+1.800.753.9221

Option 1 – Customer Care

Option 2 – Technical

Support

Europe

Netherlands:

+31 800-0200135

France:

+33 800 901 793

Europe

Germany:

800 1890272

Other Countries:

+31 13 5835404

APAC

Shanghai:

+ 86 21 2412 1618/19

Sydney:

+61 2 9751 8500



Our powerful portfolio of brands:

CADDY ERICO HOFFMAN ILSCO SCHROFF TRACHTE

