

Varistar CP Cabinet Frame, 47 U, 2200H, 800W, 1200D

Data Solutions

KATALOGNUMMER

20630-122

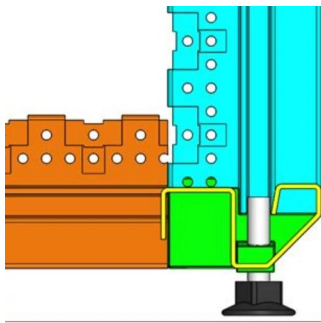
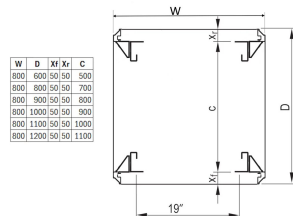
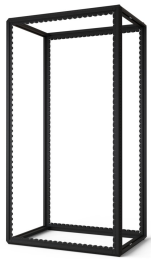

Varistar CP welded frame is available for static load requirements and can be integrated with 19", ETSI or mounting plate. Additionally, castors can be added to the frame if needed.

However, if you require castors for your application, you might want to consider a mobile frame that already includes castors.

FUNKTIONER

Welded, finish powder-coated, black gray, RAL 7021

St, 1.5 mm, zinc-plated, with central GND/grounding point

Static load-carrying capacity max. 1600 kg

Please order adjustable feet separately

PRODUKTEGENSKABER

Rack Height: 47U

Højde: 2200mm

Bredde: 800mm

Dybde: 1200mm

Pakke mængde: 1

Farve: Black Grey

Farvekode: RAL 7021

Complies With: IEC 61587-1; IEC 61587-3

Frame Material: Stål

Materiale: Stål

Produktfamilie: Varistar CP

Product Type: Cabinet/Rack Frame

Static Load: 1600kg

Type: Standard

Works With: Varistar CP

Net Weight: 41.819kg

YDERLIGERE PRODUKTOPLYSNINGER

Castor can be added to the frame. If you will need a castor for your application, you can order a mobile frame which include castors.

ADVARSEL

nVent-produkter skal kun installeres og anvendes som angivet i nVents produktvejledninger og træningsmaterialer. Vejledninger er tilgængelige på www.nvent.com og hos din nVent kundeservicerepræsentant. Forkert installation, misbrug, fejlanvendelse eller anden undladelse af fuldt ud at følge nVents instruktioner og advarsler kan medføre funktionsfejl, materielle skader, alvorlige personskader eller død og/eller ugyldiggøre din garanti.



Vores kraftfulde portefølje af mærker:

CADDY ERICO HOFFMAN ILSCO SCHROFF TRACHTE